

Due to the small surface area available for glue spots on our range of letterbox packaging there is a correct assembly method that must be followed to ensure product integrity.

This guide applies to iSL3, SL0+, SL180, SL1, SL2-343, SL3 range of letterbox friendly packaging.

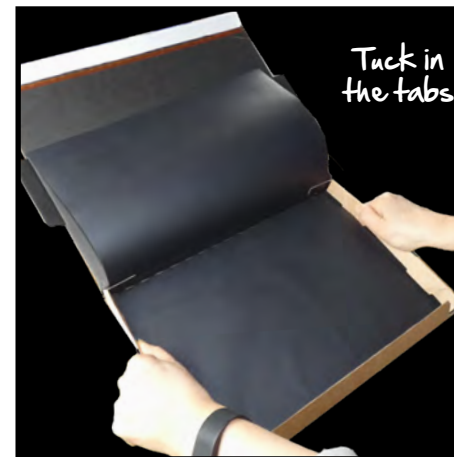
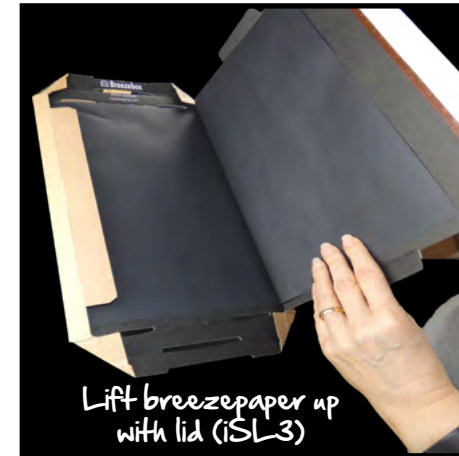
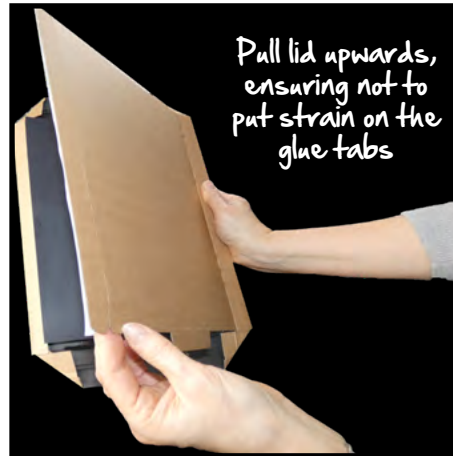

Europe's largest independent producer of eCommerce postal packaging to internet retailers.  
01480 396200 | [sales@lilpackaging.com](mailto:sales@lilpackaging.com) | Discover more at [www.lilpackaging.com](http://www.lilpackaging.com)